

Thank you for purchasing your new SKIMZ Zeolite Auto Reactor.

Model	Pump	Total Watts (W)	Zeolite Media (L)	Dimensions (mm)	For Aquarium
ZAR127	QP4.0 DC	max 30	up to 1.2	157 x 170 x 460	up to 480L
ZAR157	QP7.0 DC	max 60	up to 3.5	190 x 207 x 520	up to 1,400L

SAFETY INSTRUCTIONS

Check that the voltage shown on the label of the pump corresponds to the voltage of the main supply.

Disconnect all electrical appliances from the main before placing your hands in the water.

The pump is protected against overheating. Never allow the pump to run dry.

MAINTENANCE

It is recommended to clean the pumps every 3 to 6 months. Check and clean the impeller, and if necessary soak the pump and impeller in white vinegar to dissolve any calcium deposits.

WARRANTY POLICY

AAP Marketing Pte Ltd (Company) warrants this product to the original purchaser against defective material and workmanship that occurs during normal use of the body for two (2) years and one (1) year warranty on the pump. Company will, at Company's option, either repair or replace without charge.

PRODUCTS COVERED BY WARRANTY

All Skimz equipment is covered by warranty from the date of purchase.

To be effective, register your product at: www.skimz.sg, product warranty within 14 days of the product's purchase date.

Exclusions:

Damage resulting from accident, misuse, lack of reasonable care, subjecting the product to abnormal working conditions or any other failure not resulting from defects in materials or workmanship.

Damage caused by tampering, modification or attempted repair by anyone other than the Company.

Transfer of product to someone other than the original purchaser.

Bring the product to your nearest Skimz dealer or ship the product, together with a copy of the purchase receipt or other evidence of purchase to:

AAP Marketing Pte Ltd
 5 Ang Mo Kio Industrial Park 2A
 #04-30 AMK Tech II
 Singapore 567760

You must pay any postage, shipping charges, insurance costs and other expenses to return the product to AAP. However, if the necessary repairs are covered by the warranty, Company will pay the return shipping charges.

QUICK INSTALLATION GUIDE



Zeolite Auto Reactor
 ZAR127 • ZAR157





- A. Reactor body
- B. Thumb screw
- C. Quick dosing access
- D. DC circulation pump
- E. Controller
- F. 24VDC power supply

STEP 1

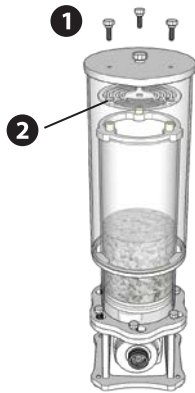

1. Remove the external casing by removing the thumbscrews.
2. Remove filter plate.
3. Add zeolite media according to the tank water volume, every 0.1L media supports 40L of water. Recommended media size 8 – 16mm or ZEOvit media.
4. Rinse media under water to remove fine particles before use and assemble the reactor in reverse order.
5. Position reactor in the sump with water levels between 180-230mm (7"-9").
6. Connect the controller to pump and power up.

STEP 2

SETUP

1. Press **FLOW** button to choose the available 4 pre-set media volume :

ZAR127 - 1=0.3L, 2=0.6L, 3=0.9L, 4=1.2L
 ZAR157 - 1=0.9L, 2=1.8L, 3=2.7L, 4=3.5L

2. Press **Manual Flush** to purge excess air in the reactor when you setup for the first time, dosing bacteria and media change.

- Press and hold button activate **Manual Flush**.

3. Turn **Dial** clockwise or anti-clockwise to adjust **Flush Time** to 10 sec per cycle.

Flush Time Per Cycle = Media flush up and down

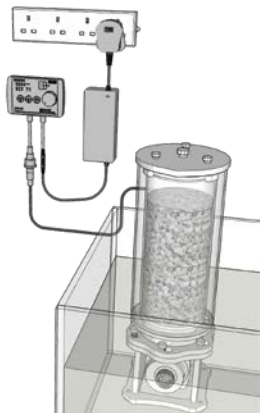

STEP 3



FLOW - 2x- PAUSE - DIAL

FLOW - Press **FLOW** button to choose the 4 pre-set media volume.

2x - Press **2x** button to double the **Flow Rates** of the selected media added.

PAUSE - Press **PAUSE** button to pause the pump for 10 min.

DIAL - Turn **DIAL** to adjust **Flush Time Per Cycle**.

STEP 4



- -

- Press and hold button to toggle **Mode 1** (old twice a day flushing) or **Mode 2** (new hourly flushing).

2 Pre-Set Flushing Mode

Mode 1 – Reactor flushes media 120 secs twice a day.
Mode 2 – Reactor flushes media 45 secs every hourly.

- Press and hold button activate **Manual Flush** when you setup for the first time, dosing bacteria and media change. Flush duration is 3 min.

- Press and hold button **Lock** controller buttons.

STEP 5

Following is the reference table for setting up the **Flow Rate** according to the media added in the reactor.

ZAR127

Flow	Flow Rate (L/h)	2x(L/h)	Media (L)	Tank Size (L)
1	60	120	0.3	120
2	120	240	0.6	240
3	180	360	0.9	360
4	240	480	1.2	480

ZAR157

Flow	Flow Rate (L/h)	2x(L/h)	Media (L)	Tank Size (L)
1	180	360	0.9	360
2	360	720	1.8	720
3	540	1080	2.7	1080
4	700	1400	3.5	1400

