

Thank you for purchasing your new Skimz Biopellet Reactor that provides optimum performance with maximum safety and reliability.

Model	Feed Pump	Body Diameter (mm)	Biopellet Media	For Aquarium	Code
BR86	QE0.8	80	up to 400ml	up to 400 L	8327-00
BR106	QE1.2	100	up to 1,000ml	up to 1,000 L	8328-00
BR156	QE2.0	150	up to 2,000ml	up to 2,000 L	8329-00

MAINTENANCE

It is recommended to clean the reactor when new media is replaced. The feed pump, reactor and sponges should be cleaned to ensure that it does not blocked with debris from the tank or calcium deposits.

WARRANTY POLICY

Skimz Singapore LLP (Company) warrants this product to the original purchaser against defective material and workmanship that occurs during normal use of the body for two (2) years and one (1) year warranty on the pump. Company will, at Company's option, either repair or replace without charge.

PRODUCTS COVERED BY WARRANTY

All Skimz equipment is covered by warranty from the date of purchase.

To be effective, register your product at: www.skimz.sg, product warranty within 14 days of the product's purchase date.

Exclusions:

Damage resulting from accident, misuse, lack of reasonable care, subjecting the product to abnormal working conditions or any other failure not resulting from defects in materials or workmanship.

Damage caused by tampering, modification or attempted repair by anyone other than the Company.

Transfer of product to someone other than the original purchaser.

Bring the product to your nearest Skimz dealer or ship the product, together with a copy of the purchase receipt or other evidence of purchase to:

AAP Marketing Pte Ltd
5 Ang Mo Kio Industrial Park 2A
#04-30 AMK Tech II
Singapore 567760

You must pay any postage, shipping charges, insurance costs and other expenses to return the product to Skimz. However, if the necessary repairs are covered by the warranty, Company will pay the return shipping charges.

QUICK INSTALLATION GUIDE

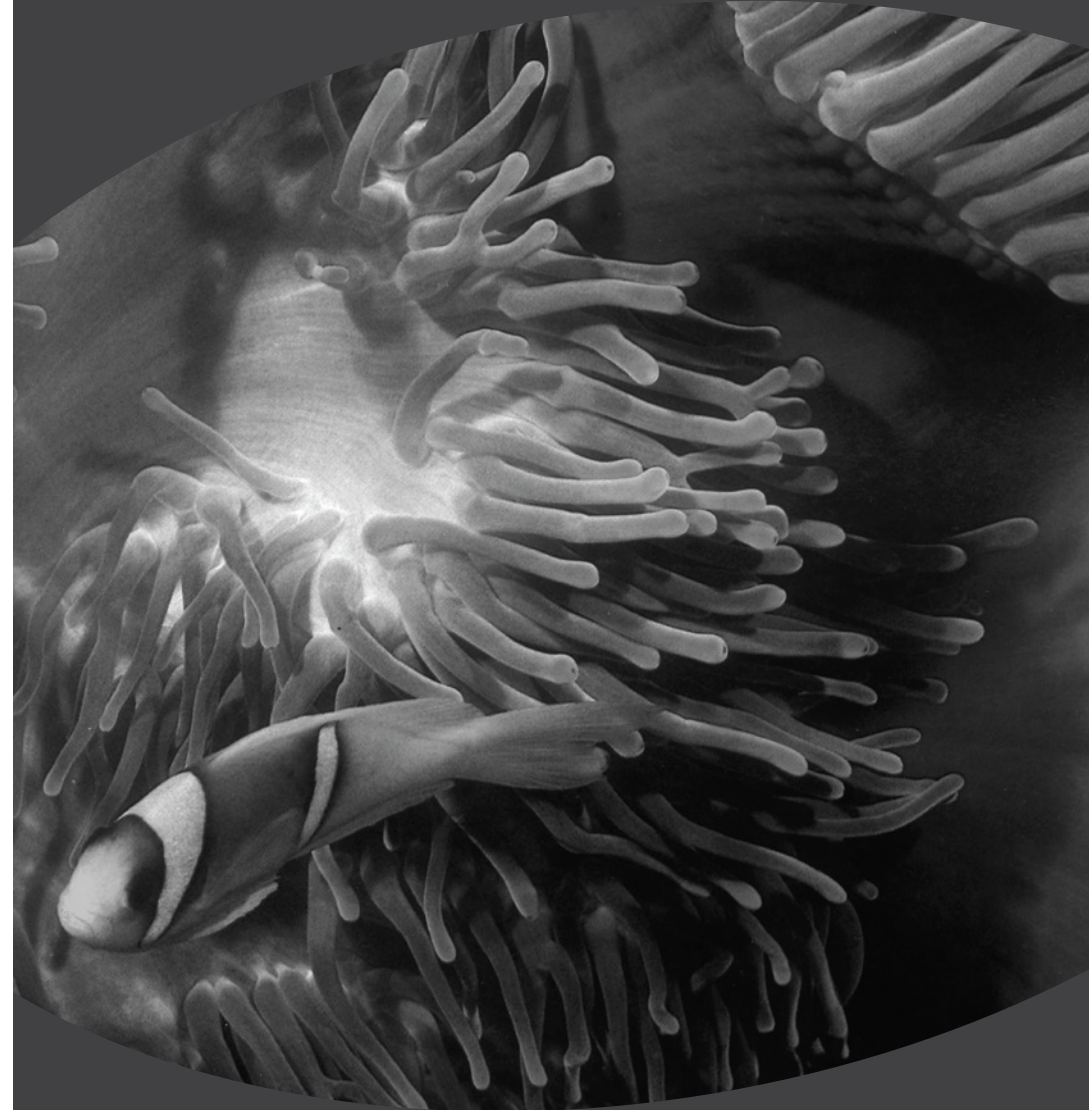

BIOPELLET REACTOR
BR86



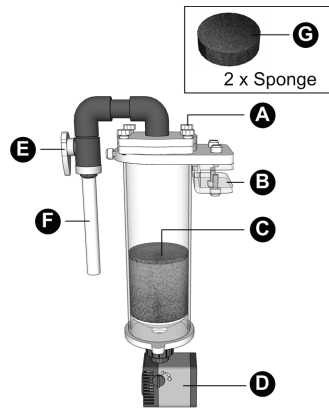

- A. Thumbscrew
- B. Mounting bracket
- C. Reactor media
- D. Feed pump
- E. Water outlet valve
- F. Outlet hose
- G. Sponge (only when using it as fluidized reactor)

STEP 1

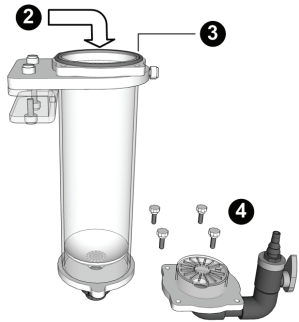

1. Open the lid by removing the thumbscrews.
2. Fill the reactor with required volume of media.
3. Check the O-ring is properly fitted.
4. Reattach the cover and tighten the thumbscrews.

STEP 2

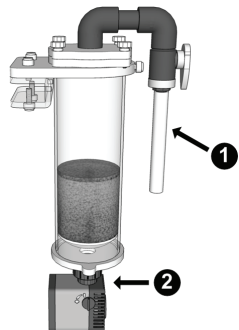

1. Attach the flexible hose to outlet of the reactor.
2. Connect the feed pump to inlet of the reactor.

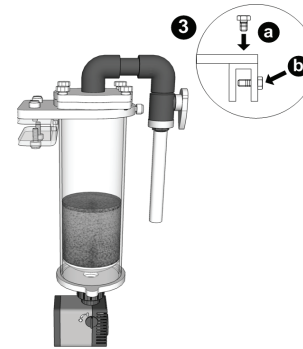

STEP 3

1. BR86 can be used inside the aquarium or in-sump.
2. It comes with two holding systems for individual fixing, and is adjustable in height.
3. Remove the (a) screw and turn the (b) fixing bracket.

STEP 4



1. Position the reactor inside the aquarium or sump.
2. Ensure the valve of the feed pump is closed and outlet hose is in the sump tank. Switch on the feed pump and open the valve slowly.
3. Adjust the flow rate until all the media is tumbling, so that it will keep the media free of biofilm.

STEP 5

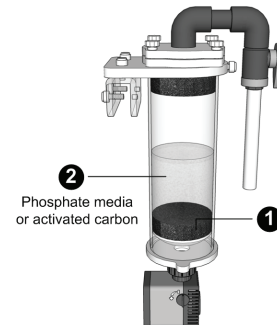

When using BR86 as fluidized Reactor

1. Inset one sponge at bottom and one at the top inside the cylinder body.
2. It can be used with phosphate media or activated carbon.
3. Switch on the feed pump and adjust the flow rate until the media starts to fluidize.
4. When fluidizing media, we suggest that the flow must not be too strong to avoid media disintegration. A general guide is to provide sufficient flow such that the surface of the media are moving gently.